

AI PEDESTRIAN DETECTION CAMERA



SPECIFICATION



- Image Sensor 1/2.9 Color CMOS
- Effective Pixels 1920(H) X 1080(V)
- Horizontal Resolution 1080P
- Viewing angle 130°
- Alarm I/O External buzzer
- Signal-to-noise ratio $\geq 48\text{dB}$ (AGC Off)
- Video output AHD 1080P
- shell material Aluminum alloy
- waterproof level IP69K
- Operating Voltage DC 12V \pm 10%
- Vibration resistance level 5G (in line with GB-T2423056-2006 s
- Body interface 4-core aircraft female head
- Product Size 74(W) x 64(H) x 56(D) mm

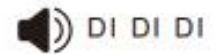

Pedestrian
Detection



Vehicle
Detection



Non-motor
Vehicle Detection

SIZES



Front View

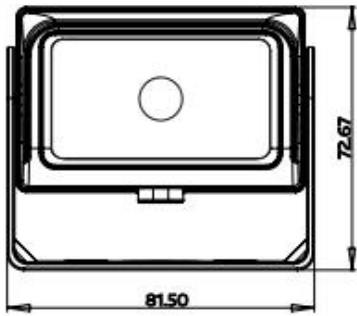

Side View

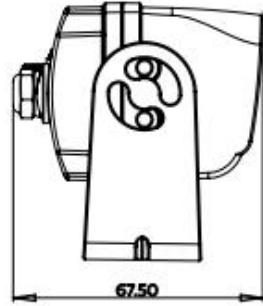

Bracket Dimensions

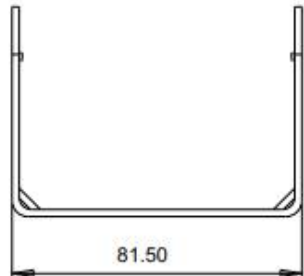

Bracket Dimensions

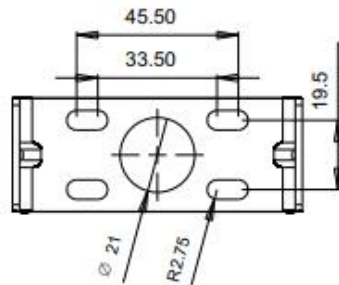

4-pin female connector definition Aviation



1	Power (Red)
2	Ground (Black)
3	I/O (Green)
4	Video (Yellow)

PACKAGES

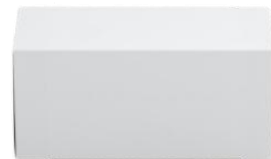

APPLICATION



Construction vehicles

-These include bulldozers, excavators, cranes, loaders, and dump trucks used to move earth and materials on construction sites.

-These include tractors, plows, harvesters, and sprayers used in farming.

Commercial vehicles

- These include trucks, vans, and buses used for transportation and delivery of goods and passengers.



Installation Diagram